



THE WORLD LEADER IN
FUME EXTRACTION TECHNOLOGY

PureBEAUTY Salon Guard

BEAUTY

Last Updated on 01.08.2018



The complete mobile extraction solution for salon hair treatments.

The BOFA Pure Beauty Salon Guard is a mobile fume extraction and filtration system that has been designed specifically to capture and remove the harmful fumes generated when carrying out hair treatments.

The health risks associated with Keratin based hair treatments have been well documented in the media but there are broader Health and Safety issues that must be considered when undertaking other hair treatments such as perming, colouring and bleaching.

Until now a practical solution for the removal of hazardous fumes has not been available. The Pure Beauty Salon Guard addresses Health & Safety concerns, requires no fixed installation, is cost effective and allows the stylist to work freely yet safely.

Technology



Advanced carbon
filter (ACF)
technology



ProTECT service
plan



SureCHECK
quality standard

Key features of the PureBEAUTY Salon Guard

Low noise level
Standard

Deep bed chemical filter
Standard

VOC sensing (Volatile Organic Compound)
Optional

Fully portable
Standard

Effective receptor capture hood
Standard

Contact BOFA at <https://bofainternational.com/us/contact/>
<https://bofainternational.com/us/portal/datasheets/purebeauty-salon-guard/>



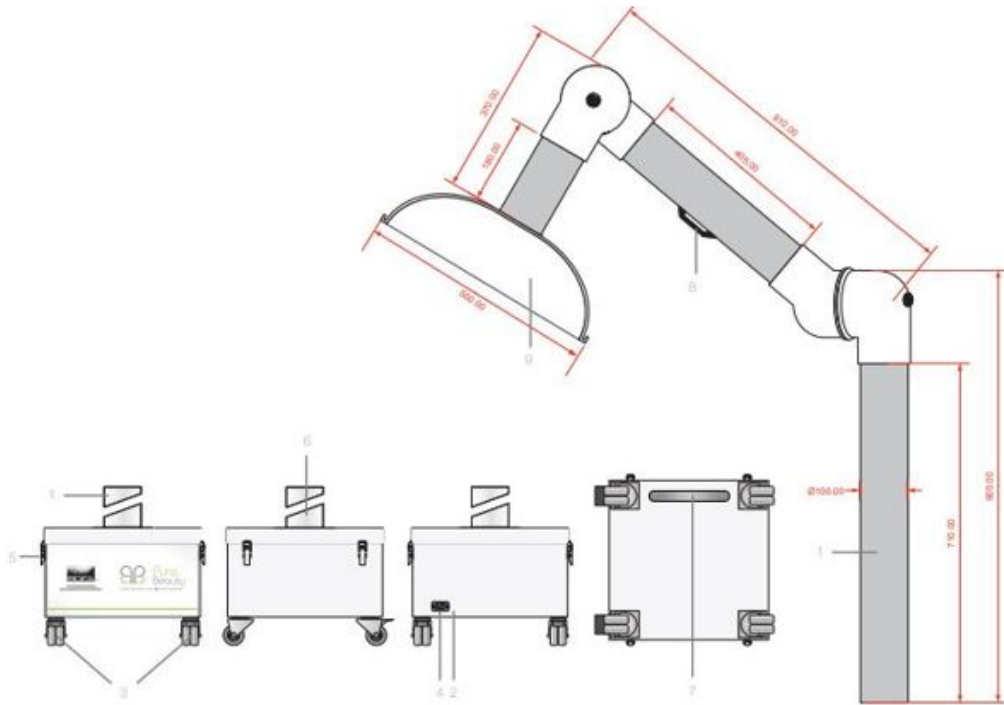

Technical specification

- | | | | |
|--------------------------|-------------------------------|-------------------|----------------|
| 1. Extractor arm - 100mm | 2. On / Off switch | 3. Double castors | 4. Power inlet |
| 5. Filter housing latch | 6. 100mm arm inlet connection | 7. Exhaust outlet | 8. Arm handle |
| 9. Hood | | | |



Airflow through filters

-  Chemical filter
-  Clean air
-  Contaminated air

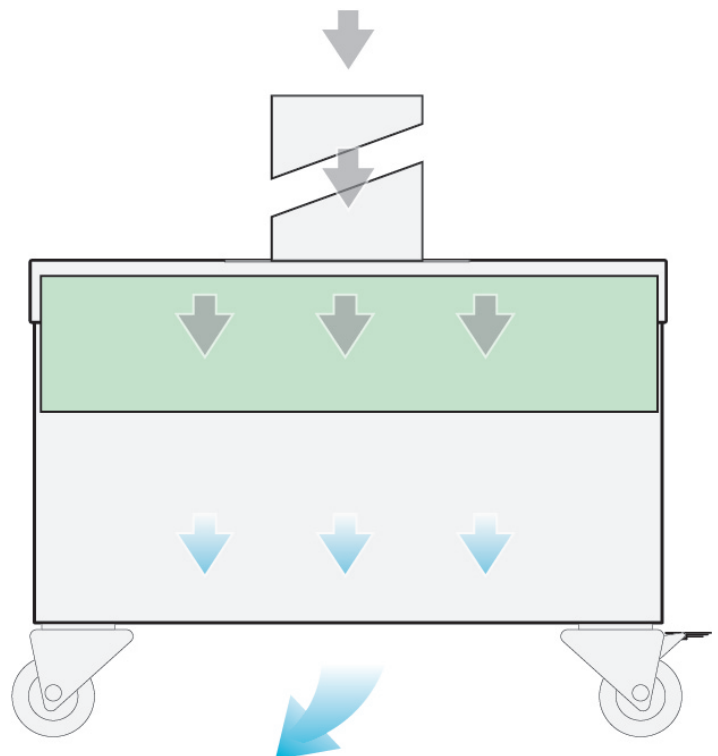

Part numbers

Model	Voltage	Part number	VOC monitoring
PureBEAUTY Salon Guard - Powder coated	230V	E2342A	A2003

Replacement filter

Model	Chemical filter
PureBEAUTY Salon Guard	A1030256

Technical data

	230V
Dimensions (HxWxD)	350 x 455 x 455mm
Cabinet construction	Powder coated mild steel
Airflow / Pressure	380m³/hr / 30mbar
Electronical Data	230V 1ph 50Hz FLC 1.9 Amps 280 Watts
Noise level	< 60dBA (At typical operating speed)
Weight	42kg

Datasheet correct at time of publishing. For specific applications, please contact us for details.

 **BARCELONA INSTRUMENTS
ELECTRONICS, S.L.**
Roselló, 20 - 08029 BARCELONA
Tel.: 93 280 29 89 - Fax: 93 280 41 13
ventas@bielec.es

