



A Donaldson Company

A WORLD LEADER IN FUME
EXTRACTION TECHNOLOGY

DentalPRO Xtract 300

DENTAL

Last Updated on 18.12.2018



Dust and fume extraction cabinet for multiple hand finishing dental laboratory applications.

BOFA's DentalPRO Xtract 300 dust and fume extraction dental cabinet is designed for the effective removal of potentially harmful dust and fumes generated during dental hand finishing or Monomer mixing applications.

This unit is ideally suited to manual bench top applications and provides technicians the flexibility to work without restriction in the knowledge that dust particles and fumes are being effectively removed to maintain a safe working environment.

This system combines maximum technician protection in one compact unit, with scalable and flexible options with different accessories, lighting and internal storage.

Compatible with the DentalPRO 400 and DentalPRO Mono extraction systems.

Technology



ProTECT service
plan



SureCHECK
quality standard

Key features of the DentalPRO Xtract 300

Easily replaced screen protector ensures clear visibility at all times

Standard

Padded arm rests

Standard

Rear entry grommets for mains powered hand finishing units

Standard

Removable collection tray

Standard

Powder coated white

Standard

Internal storage trays

Standard

Internal LED lighting

Standard

Interchangeable accessories

Standard

Strong rigid construction

Standard

Internal down draught tray

Standard

Contact BOFA at <https://bofainternational.com/en/contact/>

<https://bofainternational.com/en/portal/datasheets/dentalpro-xtract-300/>



Internal bench peg attachment
Optional

DentalPRO 400 filtration system
Optional

Internal saw table
Optional

DentalPRO Mono filtration system
Optional

Technical specification

- | | | | |
|---------------------------------|--------------------------------|-------------------------------------|----------------------------------|
| 1. Clear Polycarbonate visor | 2. Disposable visor shield | 3. Power cable for lighting | 4. Arm rests with foam pads |
| 5. Arm rest locking screws | 6. Removable bottom panel tray | 7. Grommet holes for locating tools | 8. Internal LED strip light |
| 9. Internal storage compartment | 10. Visor hinges | 11. Extraction outlet - 75mm | 12. Removable down draught table |

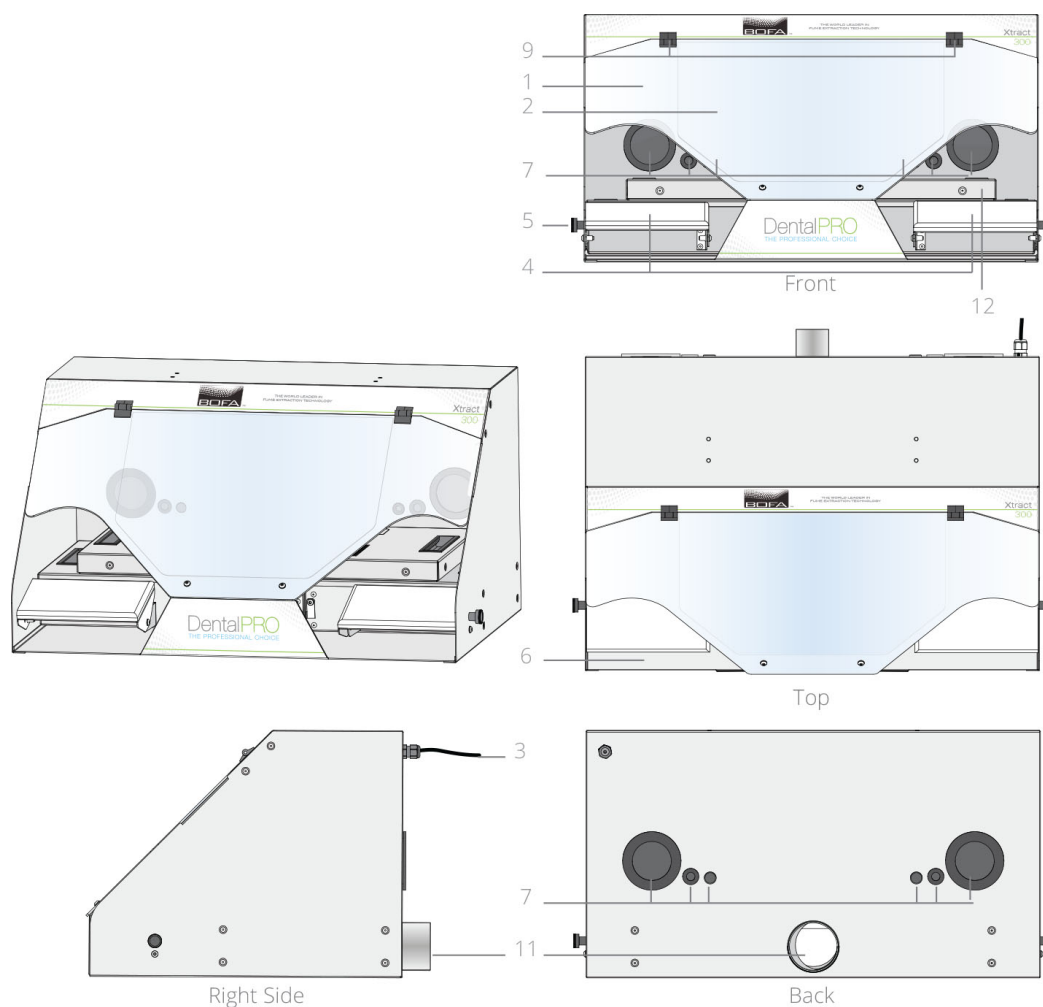

Accessories technical specification

1. Internal down draught tray (standard accessory)
2. Internal saw table (optional accessory)
3. Internal bench peg (optional accessory)

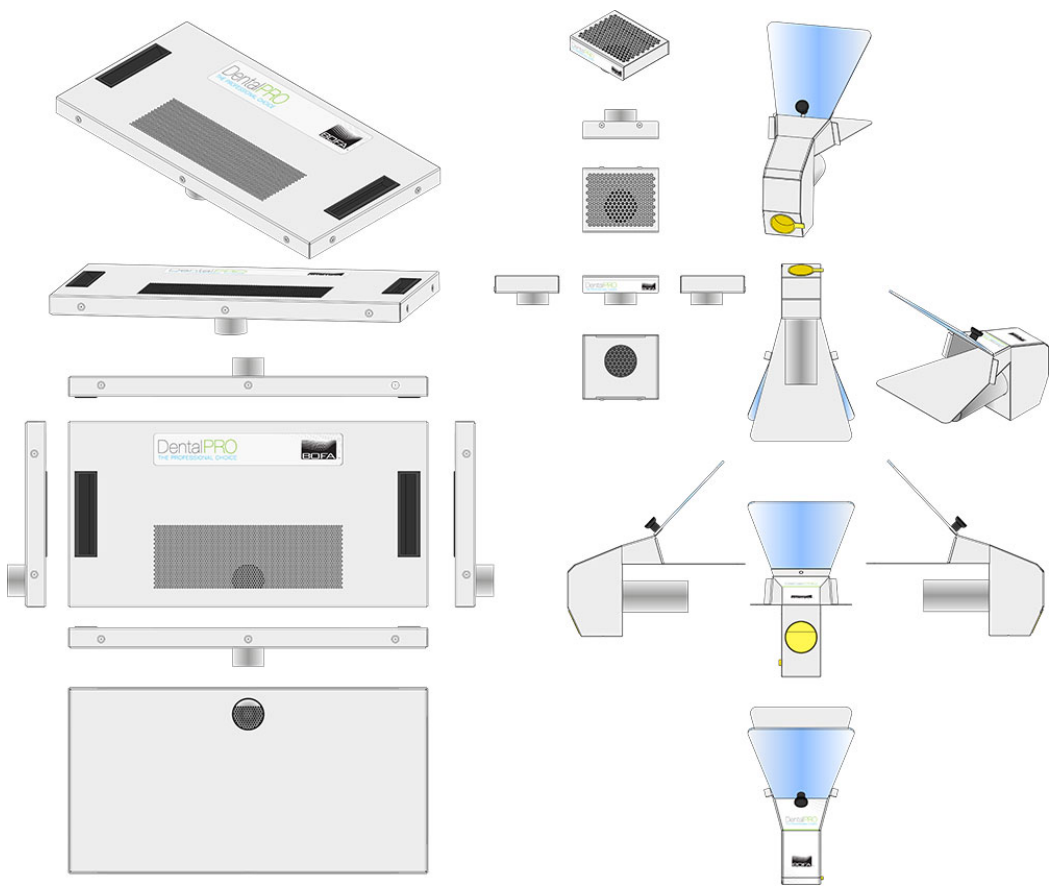

Airflow through unit

- Contaminated air
- LED Lighting

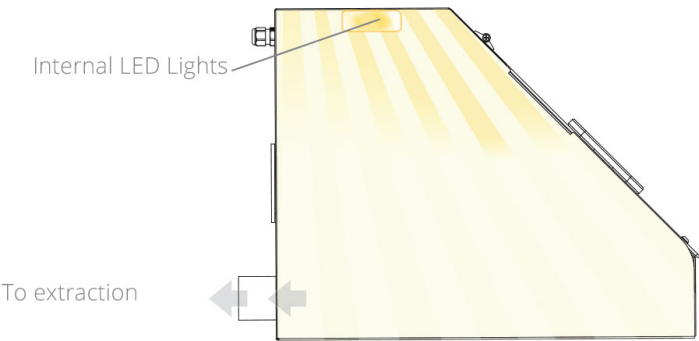

Technical data		
	EU	US
Dimensions	380 x 730 x 520mm	14.96 x 28.74 x 20.47"
Opening dimensions (HxW)	380 x 695mm	14.96 x 27.36"
Cabinet construction	Powder coated mild steel	Powder coated mild steel
Voltage	100-240V 0.6A	100-240V 0.6A

Technical data

Weight	30kgs	66lbs
Approvals	CE	CE

Cabinet part numbers

Model	Part number
DentalPRO Xtract 300 + internal down draught tray	D0947A0000
Options	
Saw table	A375040
Internal bench peg	A375400

Hose kit part numbers (needed if ordering extraction system)

Description	Part number
Hose kit to connect extraction system to DentalPRO Xtract cabinet	A1020068

Optional extraction system part numbers

DentalPRO 400	-----	-----	-----
Model	Option	Voltage	Part number
DentalPRO 400 Powder coated unit Twin port 75mm lid		90V - 257V	DL0944A0000
DentalPRO 400 Powder coated unit Twin port 75mm lid	24V Stop / Start Override Filter Change Signal	90V - 257V	DL0944A0001
Unit options			
Foot switch (ON / OFF operation)			A1070184
DentalPRO Mono	-----	-----	-----
Model		Voltage	Part number
DentalPRO Mono Powder coated unit Single port 75mm lid		230V	DL2043A0000
DentalPRO Mono Powder coated unit Single port 75mm lid		115V	DL2041A0000

Datasheet correct at time of publishing.

Where applicable, the carbon used in BOFA units is capable of removing a wide range of VOC's, however it is the responsibility of the user to ensure the carbon is suitable for their application. For specific applications, please contact us for details.

Think before you print! Please consider the environment before printing this document.